

# DRILL SERIES

**Introducing...**  
**The New Signature Series Drills**  
**For Today's Manufacturing Industry**



# DRILL SERIES

## Performance, Serviceability, Ergonomics and Value...



Light weight aluminum housing



Ergonomic, handle with soft textured grip



Available in 1 HP and .6HP motor



3 planet gear system for increased life and load capacity



Teasing throttle, conveniently located reverse

### Powerful Tools for every application

Through next generation ergonomics and the continued focus on productivity and operator safety comes the development of the Sioux Tools Signature Series Drill line. Signature Series Drills are used in applications ranging from manufactured housing and wood working to light assembly. The powerful five vane motor makes these drills great for drilling applications that contain ferrous and non-ferrous metals, wood and composite materials. The Signature Series Drills offer great value with a 3 planet gear system for increased life and load capacity. The Sioux tools Signature Series Drill line reduces operator fatigue by offering a low sound level and low vibration solution! Operator comfort is achieved through the implementation of a light weight aluminum housing and a comfort grip. Drills are available in both reversing and non-reversing pistol grip and lever handle configurations.

### The Signature Series



Inspired by the operator, designed by Sioux Tools. Since 1914, Sioux Tools has been committed to bringing productive solutions to the pneumatic power tool industry.

Signature Series is an innovative pneumatic power tool program created through the implementation of next generation ergonomics, productivity enhanced features, serviceability and value.

Through industry research and operator input, we have engineered a program that truly delivers tools for the way you work!





SDR10P26N3



SDR10P26NK3



SDR10P25R3



SDR10S26N3

**Drills**



Model Number	Free Speed	Chuck Capacity		Weight		Length		Side to Center		Air Consumption		Sound Level	Spindle Thread
	rpm	in.	mm	lb.	kg	in.	mm	in.	mm	scfm	l/s	dB(A)	
<b>Pistol Grip Non-Reversing Drills (1.0 HP)</b>													
SDR10P210N2	21,000	1/4	6	1.85	.84	6.6	168	0.8	20	30	14.2	80	3/8"-24
SDR10P60N2	6,000	1/4	6	2.30	1.05	6.5	165	0.8	20	30	14.2	80	3/8"-24
SDR10P60N3	6,000	3/8	10	2.45	1.10	7.0	180	0.8	20	30	14.2	80	3/8"-24
SDR10P40N2	4,000	1/4	6	2.30	1.05	6.5	165	0.8	20	30	14.2	80	3/8"-24
SDR10P40N3	4,000	3/8	10	2.45	1.10	7.0	180	0.8	20	30	14.2	80	3/8"-24
SDR10P26N2	2,600	1/4	6	2.30	1.05	6.5	165	0.8	20	30	14.2	80	3/8"-24
SDR10P26N3	2,600	3/8	10	2.45	1.10	7.0	180	0.8	20	30	14.2	80	3/8"-24
SDR10P26N4	2,600	1/2	13	2.90	1.30	7.5	190	0.8	20	30	14.2	80	1/2"-20
SDR10P16N3	1,600	3/8	10	2.90	1.30	8.0	205	0.8	20	30	14.2	80	1/2"-20
SDR10P12N3	1,200	3/8	10	2.90	1.30	8.0	205	0.8	20	30	14.2	80	1/2"-20
SDR10P7N3	700	3/8	10	2.90	1.30	8.0	205	0.8	20	30	14.2	80	1/2"-20
SDR10P7N4	700	1/2	13	3.30	1.50	8.5	215	0.8	20	30	14.2	80	1/2"-20
SDR10P4N3	400	3/8	10	2.90	1.30	8.0	205	0.8	20	30	14.2	80	1/2"-20
SDR10P4N4	400	1/2	13	3.30	1.50	8.5	215	0.8	20	30	14.2	80	1/2"-20
<b>Pistol Grip Non-Reversing Keyless Chuck Drills (1.0 HP) with Röhm Chucks</b>													
SDR10P60NK3	6,000	3/8	10	2.85	1.30	7.6	195	0.8	20	30	14.2	80	3/8"-24
SDR10P40NK3	4,000	3/8	10	2.85	1.30	7.6	195	0.8	20	30	14.2	80	3/8"-24
SDR10P26NK3	2,600	3/8	10	2.85	1.30	7.6	195	0.8	20	30	14.2	80	3/8"-24
SDR10P26NK4	2,600	1/2	13	3.15	1.40	8.1	210	0.8	20	30	14.2	80	1/2"-20
SDR10P12NK3	1,200	3/8	10	3.30	1.50	8.6	220	0.8	20	30	14.2	80	3/8"-24
SDR10P7NK4	700	1/2	13	3.55	1.60	9.1	230	0.8	20	30	14.2	80	1/2"-20
SDR10P4NK4	400	1/2	13	3.55	1.60	9.1	230	0.8	20	30	14.2	80	1/2"-20
<b>Pistol Grip Reversing Drills (1.0 HP)</b>													
SDR10P40R2	4,000	1/4	6	2.40	1.10	7.1	180	0.8	20	30	14.2	80	3/8"-24
SDR10P40R3	4,000	3/8	10	2.55	1.15	7.6	195	0.8	20	30	14.2	80	3/8"-24
SDR10P25R2	2,500	1/4	6	2.40	1.10	7.1	180	0.8	20	30	14.2	80	3/8"-24
SDR10P25R3	2,500	3/8	10	2.55	1.15	7.6	195	0.8	20	30	14.2	80	3/8"-24
SDR10P20R2	2,000	1/4	6	2.40	1.10	7.1	180	0.8	20	30	14.2	80	3/8"-24
SDR10P20R3	2,000	3/8	10	2.55	1.15	7.6	195	0.8	20	30	14.2	80	3/8"-24
SDR10P20R4	2,000	1/2	13	3.00	1.35	7.9	200	0.8	20	30	14.2	80	1/2"-20
SDR10P12R3	1,200	3/8	10	3.10	1.40	8.6	220	0.8	20	30	14.2	80	1/2"-20
SDR10P12R4	1,200	1/2	13	3.55	1.60	9.1	230	0.8	20	30	14.2	80	1/2"-20
SDR10P7R3	700	3/8	10	3.10	1.40	8.6	220	0.8	20	30	14.2	80	1/2"-20
SDR10P7R4	700	1/2	13	3.55	1.60	9.1	230	0.8	20	30	14.2	80	1/2"-20
SDR10P5R3	500	3/8	10	3.10	1.40	8.6	220	0.8	20	30	14.2	80	1/2"-20
SDR10P5R4	500	1/2	13	3.55	1.60	9.1	230	0.8	20	30	14.2	80	1/2"-20
SDR10P3R3	300	3/8	10	3.10	1.40	8.6	220	0.8	20	30	14.2	80	1/2"-20
SDR10P3R4	300	1/2	13	3.55	1.60	9.1	230	0.8	20	30	14.2	80	1/2"-20
<b>Inline Non-Reversing Drills (1.0 HP)</b>													
SDR10S60N2	6,000	1/4	6	2.20	1.00	7.8	200	0.8	20	30	14.2	78	3/8"-24
SDR10S60N3	6,000	3/8	10	2.30	1.05	8.3	210	0.8	20	30	14.2	78	3/8"-24
SDR10S40N2	4,000	1/4	6	2.20	1.00	7.8	200	0.8	20	30	14.2	78	3/8"-24
SDR10S40N3	4,000	3/8	10	2.30	1.05	8.3	210	0.8	20	30	14.2	78	3/8"-24
SDR10S26N2	2,600	1/4	6	2.20	1.00	7.8	200	0.8	20	30	14.2	78	3/8"-24
SDR10S26N3	2,600	3/8	10	2.30	1.05	8.3	210	0.8	20	30	14.2	78	3/8"-24
SDR10S16N3	1,600	3/8	10	2.75	1.25	9.3	235	0.8	20	30	14.2	78	1/2"-20
SDR10S12N3	1,200	3/8	10	2.75	1.25	9.3	235	0.8	20	30	14.2	78	3/8"-24
SDR10S7N3	700	3/8	10	2.75	1.25	9.3	235	0.8	20	30	14.2	78	1/2"-20
SDR10S4N3	400	3/8	10	2.75	1.25	9.3	235	0.8	20	30	14.2	78	1/2"-20
SDR10S4N4	400	1/2	13	3.20	1.45	9.8	250	0.8	20	30	14.2	78	1/2"-20



SDR10S25R3



SDR6P26N3

**Drills Continued**

Model Number	Free Speed	Chuck Capacity		Weight		Length		Side to Center		Air Consumption		Sound Level	Spindle Thread
	rpm	in.	mm	lb.	kg	in.	mm	in.	mm	scfm	l/s	dB(A)	
<b>Inline Reversing Drills (1.0 HP)</b>													
SDR10S25R2	1/4	6	2500	2.2	1.00	9.3	235	0.8	19	30	14	78	3/8"-24
SDR10S25R3	3/8	10	2500	2.3	1.05	9.8	248	0.8	19	30	14	78	3/8"-24
SDR10S20R2	1/4	6	2000	2.2	1.00	9.3	235	0.8	19	30	14	78	3/8"-24
SDR10S20R3	3/8	10	2000	2.3	1.05	9.8	248	0.8	19	30	14	78	3/8"-24
SDR10S20R4	1/2	10	2000	2.8	1.25	10.3	260	0.8	19	30	14	78	1/2"-20
SDR10S12R3	3/8	10	1200	2.8	1.25	10.8	273	0.8	19	30	14	78	3/8"-24
SDR10S12R4	1/2	13	1200	3.2	1.45	11.3	285	0.8	19	30	14	78	1/2"-20
SDR10S7R3	3/8	10	700	2.8	1.25	10.8	273	0.8	19	30	14	78	1/2"-20
SDR10S7R4	1/2	13	700	3.2	1.45	11.3	285	0.8	19	30	14	78	1/2"-20
SDR10S5R3	3/8	10	500	2.8	1.25	10.8	273	0.8	19	30	14	78	1/2"-20
SDR10S5R4	1/2	13	500	3.2	1.45	11.3	285	0.8	19	30	14	78	1/2"-20
SDR10S3R3	3/8	10	300	2.8	1.25	10.8	273	0.8	19	30	14	78	1/2"-20
SDR10S3R4	1/2	13	300	3.2	1.45	11.3	285	0.8	19	30	14	78	1/2"-20
<b>Pistol Grip Non-Reversing Drills (0.6 HP)</b>													
SDR6P60N2	6,000	1/4	6	2.10	0.95	5.8	145	0.8	20	25	11.8	80	3/8"-24
SDR6P60N3	6,000	3/8	10	2.25	1.00	6.3	160	0.8	20	25	11.8	80	3/8"-24
SDR6P40N2	4,000	1/4	6	2.10	0.95	5.8	145	0.8	20	25	11.8	80	3/8"-24
SDR6P40N3	4,000	3/8	10	2.25	1.00	6.3	160	0.8	20	25	11.8	80	3/8"-24
SDR6P26N2	2,600	1/4	6	2.10	0.95	5.8	145	0.8	20	25	11.8	80	3/8"-24
SDR6P26N3	2,600	3/8	10	2.25	1.00	6.3	160	0.8	20	25	11.8	80	3/8"-24
SDR6P26N4	2,600	1/2	13	2.70	1.20	6.6	170	0.8	20	25	11.8	80	1/2"-20
SDR6P12N3	1,200	3/8	10	2.70	1.20	7.3	185	0.8	20	25	11.8	80	3/8"-24
SDR6P7N3	700	3/8	10	2.70	1.20	7.3	185	0.8	20	25	11.8	80	1/2"-20
SDR6P7N4	700	1/2	13	3.10	1.40	7.8	200	0.8	20	25	11.8	80	1/2"-20
SDR6P4N3	400	3/8	10	2.70	1.20	7.3	185	0.8	20	25	11.8	80	1/2"-20
SDR6P4N4	400	1/2	13	3.10	1.40	7.8	200	0.8	20	25	11.8	80	1/2"-20
<b>Pistol Grip Non-Reversing Keyless Chuck Drills (0.6 HP) with Röhm Chucks</b>													
SDR6P60NK3	6,000	3/8	10	2.45	1.10	6.9	175	0.8	20	25	11.8	80	3/8"-24
SDR6P40NK3	4,000	3/8	10	2.45	1.10	6.9	175	0.8	20	25	11.8	80	3/8"-24
SDR6P26NK3	2,600	3/8	10	2.45	1.10	6.9	175	0.8	20	25	11.8	80	3/8"-24

**Support Handle**  
**Part No. SPSPDR-14A**  
 For use on Signature Series Drills



# Signature Series Drill Features

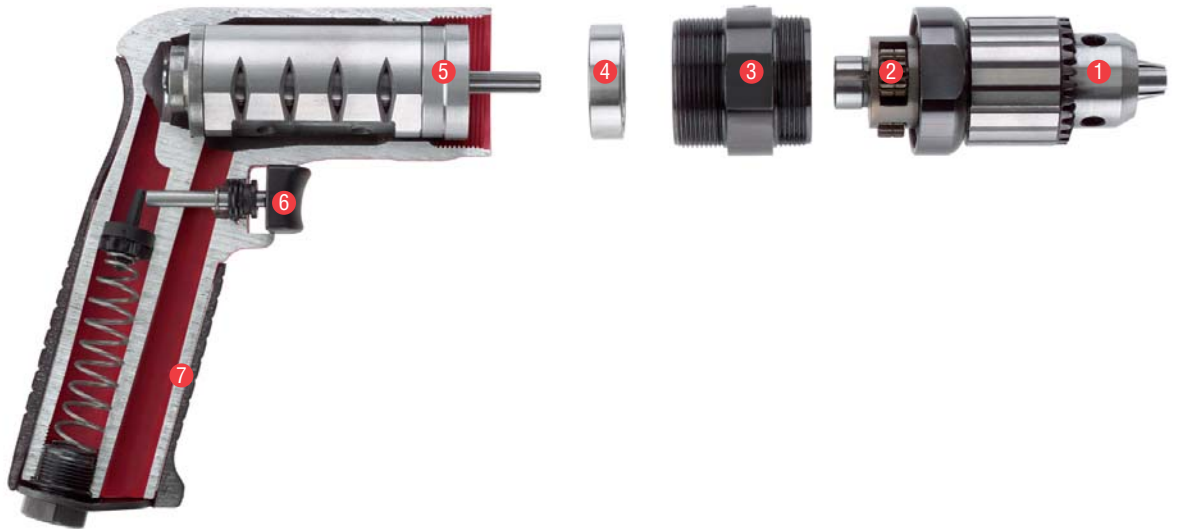

- 1 Available keyed or keyless chuck
- 2 3 planet gear system for increased life and load capacity
- 3 Ring gear
- 4 Ball bearing construction throughout
- 5 Precision machined steel motor
- 6 Teasing throttle
- 7 Cast aluminum handle with comfort grip

## Serviceability

- Ring gear is machined into the motor retainer for ease of assembly and disassembly.
- Planetary gear reduction assembly can be serviced without removing the chuck.
- Rotor pinion is case hardened to resist wear.
- Rotor, cylinder and endplates are interchangeable between different models. This reduces the number of spare parts tool cribs need to stock.
- Tipper valve and valve seat are easily accessible for service.



- Woodworking
- Truck and Tractor
- Manufacturing
- Manufactured Housing
- Marine Industry
- R.V. Industry
- Appliance Industry
- Light Assembly



[siouxtools.com](http://siouxtools.com)



*For the way you work*



250 Snap-on Drive  
P.O. Box 1596  
Murphy, North Carolina USA 28906  
PH: 828.835.9765  
FAX: 828.835.9685  
TOLL FREE: 866.259.7291  
TOLL FREE FAX: 800.722.7236

Benelux  
Tel.: (N) 31 (0) 20 568 26 64  
(B) 32 (0) 14 23 19 67  
Fax: (N) 31 (0) 20 568 26 60  
(B) 31 (0) 14 23 26 27  
e-mail: [snap@snap-on.nl](mailto:snap@snap-on.nl)

Latin America  
Tel.: 305-271-0944  
Fax: 305-271-7152  
e-mail: [latinamerica.caribbean@snapon.com](mailto:latinamerica.caribbean@snapon.com)

Germany  
Tel.: 49 2104 9509-0  
Fax: 49 2104 9509-99  
e-mail: [snapon.industrial@snapon.com](mailto:snapon.industrial@snapon.com)

Italy  
Tel.: 00 39 02 66 04 53 70  
Fax: 00 39 02 61 29 78 15  
e-mail: [indus.italia@snapon.com](mailto:indus.italia@snapon.com)

United Kingdom  
Tel.: 44 (0) 1536-413904  
Fax: 44 (0) 1536-413874  
e-mail: [industrialuk@snapon.com](mailto:industrialuk@snapon.com)

Asia  
Tel.: 65-6451-5570  
Fax: 65-6451-5574  
email: [esales.sg@snapon.com](mailto:esales.sg@snapon.com)

Australia  
Tel.: 61 2 9837 9100  
Fax: 61 2 9624 2578  
e-mail: [SOTA.customerservice@snapon.com](mailto:SOTA.customerservice@snapon.com)

Distributed By:

